

# Vehicle Door Protector™

## Care & Instructions

Made in China  
K&H Manufacturing, LLC  
Colorado Springs, CO  
www.khmfg.com | (877) 738-5188



**Thank you for purchasing K&H Manufacturing's Vehicle Door Protectors™.**  
**Proper care & installation should lead to many years of safe travel for your family & pet.**

### For installation on a window with one solid panel window:

- 1** Hold the Vehicle Door Protector™ up to the door. The more squared off end of the protector should face the front of the vehicle.
- 2** Begin gently inserting the stay tabs between the glass and the weather stripping. Insert each stay tab completely. (The molded bump will catch under the weather stripping.)
- 3** Smooth out wrinkles and adjust accordingly.
- 4** Either tuck the suction cup under the protector or remove it with scissors.



### For installation on a two-piece, rear window:

- !** Follow steps 1 through 3 to the left. Note, The rear stationary window section will not accommodate a stay tab. Do not attempt to insert a stay tab into this small immovable window section. Either fold the last stay tab under or carefully remove it with scissors. Use the suction cup on this rear window section to keep the Vehicle Door Protector™ in place.

#### **Care Instructions:** Wipe clean with a damp cloth.

**Caution:** The unique, patent pending design of the stay tabs help keep the Vehicle Door Protector™ in place when operating the window. For safety, it is recommended to only "crack" a window with a pet in a vehicle. Never leave a pet in an unattended vehicle.

#### **K&H Limited One Year Warranty**

**Our warranty is as follows:** K&H Manufacturing warrants to the original consumer, that this product will be free of defects and workmanship for a period of one year from the date of purchase. The manufacturer's liability hereunder is limited to replacement of the product. This warranty is void if the product has been damaged by accident, unreasonable use, neglect, tampering, or other causes not arising from defects in material or workmanship.

**To exercise your warranty:** If, during the warranty period, your product malfunctions, return it to the place of purchase with your **original purchase receipt**. If this cannot be done, return the product, postage prepaid, to K&H Manufacturing, with **dated proof of purchase or original date receipt**. A return authorization number, obtained by calling (719) 591-6950 must accompany all returns to manufacturer. Please include a note explaining the problem when returning the product.

# Vehicle Door Protector™

## Care & Instructions

Made in China  
K&H Manufacturing, LLC  
Colorado Springs, CO  
www.khmfg.com | (877) 738-5188



**Thank you for purchasing K&H Manufacturing's Vehicle Door Protectors™.**  
**Proper care & installation should lead to many years of safe travel for your family & pet.**

### For installation on a window with one solid panel window:

- 1** Hold the Vehicle Door Protector™ up to the door. The more squared off end of the protector should face the front of the vehicle.
- 2** Begin gently inserting the stay tabs between the glass and the weather stripping. Insert each stay tab completely. (The molded bump will catch under the weather stripping.)
- 3** Smooth out wrinkles and adjust accordingly.
- 4** Either tuck the suction cup under the protector or remove it with scissors.

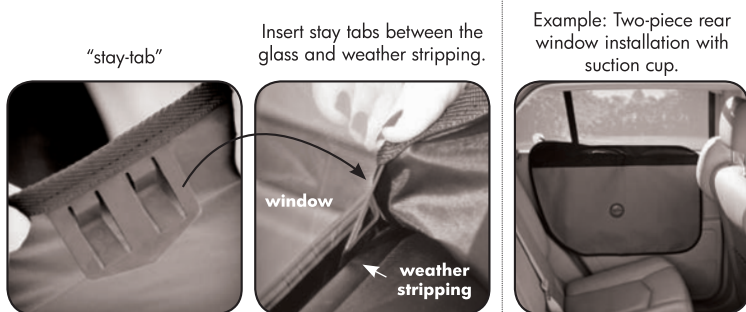

### For installation on a two-piece, rear window:

- !** Follow steps 1 through 3 to the left. Note, The rear stationary window section will not accommodate a stay tab. Do not attempt to insert a stay tab into this small immovable window section. Either fold the last stay tab under or carefully remove it with scissors. Use the suction cup on this rear window section to keep the Vehicle Door Protector™ in place.

#### **Care Instructions:** Wipe clean with a damp cloth.

**Caution:** The unique, patent pending design of the stay tabs help keep the Vehicle Door Protector™ in place when operating the window. For safety, it is recommended to only "crack" a window with a pet in a vehicle. Never leave a pet in an unattended vehicle.

#### **K&H Limited One Year Warranty**

**Our warranty is as follows:** K&H Manufacturing warrants to the original consumer, that this product will be free of defects and workmanship for a period of one year from the date of purchase. The manufacturer's liability hereunder is limited to replacement of the product. This warranty is void if the product has been damaged by accident, unreasonable use, neglect, tampering, or other causes not arising from defects in material or workmanship.

**To exercise your warranty:** If, during the warranty period, your product malfunctions, return it to the place of purchase with your **original purchase receipt**. If this cannot be done, return the product, postage prepaid, to K&H Manufacturing, with **dated proof of purchase or original date receipt**. A return authorization number, obtained by calling (719) 591-6950 must accompany all returns to manufacturer. Please include a note explaining the problem when returning the product.